

CO₂ Component Description

Pneumatic Detection System Tubing Fittings

Effective: January 2015

K-81-7060



Tubing Nut, 3/16" (Marine)
P/N WF-528103-000

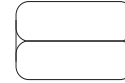

Union, 3/16" without Nuts (Marine)
P/N WK-528103-600



Tee, 3/16" without Nuts (Marine)
P/N WK-528103-700

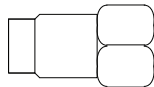

Tubing Nut, 1/8"
P/N WK-207648-000

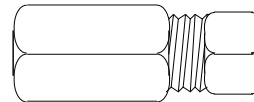

Union, 1/8" x 3/16", with 1/8" Nut
P/N 81-802536-000

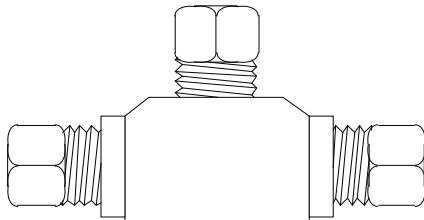

Tee, 1/8" with Nuts
P/N 81-802537-000

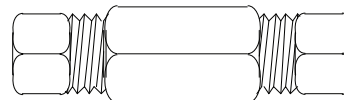

Union, 1/8" with Nuts
P/N 81-802535-000

MATERIAL: BRASS
ALL FITTINGS S.A.E. INVERTED FLARE

This literature is provided for informational purposes only. KIDDE-FENWAL, INC. assumes no responsibility for the product's suitability for a particular application. The product must be properly applied to work correctly. If you need more information on this product, or if you have a particular problem or question, contact KIDDE-FENWAL, Inc.

Kidde is a registered trademark of Kidde-Fenwal Inc. All other trademarks are the property of their respective owners.